

Overview

Cisco Catalyst 2960-S Series Switches WS-C2960S-24TS-L is a model, designed for enterprise, midmarket, and branch office networks equally. It has 24 RJ-45 10/100/1000Base-T Network LAN ports and provides LAN Base feature set.

Quick Specs

Figure 1 shows the appearance of the WS-C2960S-24TS-L.



Table 1 shows the Quick Spec of the WS-C2960S-24TS-L.

Product Code	WS-C2960S-24TS-L
Enclosure Type	Rack-mountable - 1U
Feature Set	LAN Base
Uplink Interfaces	Four 1G Small Form-Factor Pluggable(SFP)
Downlink Ports	24 × Ethernet 10/100/1000 ports
Expansion Slot(s)	1 (total) / 1 (free) × Stacking Module
Switching capacity	176 Gbps
Forwarding performance (64-byte packet size)	41.7 Mpps
DRAM	128 MB
Flash Memory	64 MB
Dimensions	44.5 × 38.6 × 4.5 cm
Package Weight	9.19 Kg

Product Details



Figure 2 shows the front panel of the WS-C2960S-24TS-L.

(1)	Mode Button	(5)	USB Type A Port
(2)	LED display	(6)	USB mini-Type B (console) Port
(3)	24 × Ethernet 10/100/1000 ports	(7)	Ethernet Management Port
(4)	SFP Module Slots	(8)	RJ45 Console Port

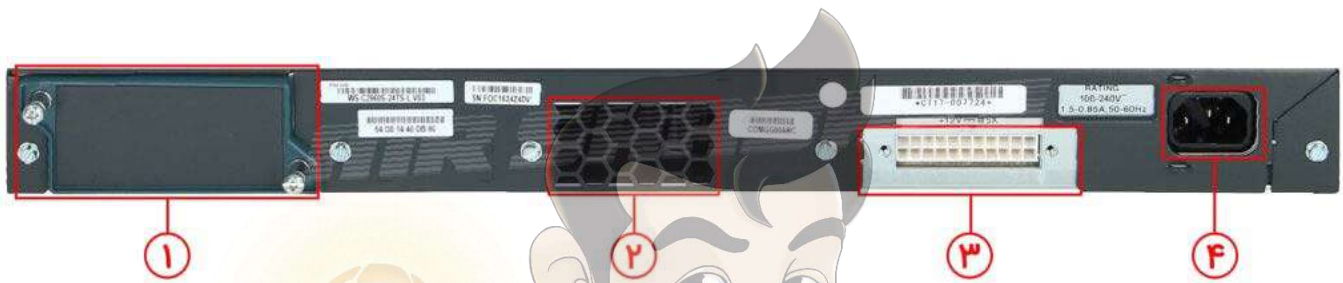

Figure 3 shows the back panel of the WS-C2960S-24TS-L.

(1)	1 (total) / 1 (free) x Stacking Module	(3)	RPS Connector
(2)	Fan Exhaust	(4)	AC power connector

Compare to Similar Items

Table 3 shows the comparison of similar items.

Models	WS-C2960S-24TS-L	WS-C2960S-24PS-L
PoE Available	No	Yes
Ports	24 × Ethernet 10/100/1000 ports FP)	24 × Ethernet 10/100/1000 PoE+ ports FP)
Switching Capacity	176 Gbps	176 Gbps
Uplinks	4 x 1G SFP	4 x 1G SFP
Feature Set	LAN Base	LAN Base
Stackable	Yes	Yes

The Accessories

Table 2 shows some accessories of the WS-C2960S-24TS-L.

Models	Description
C2960S-STACK	Catalyst 2960S FlexStack Stack Module optional for LAN Base
GLC-LH-SM	GE SFP, LC connector LX/LH transceiver
GLC-SX-MMD	1000BASE-SX SFP transceiver module, MMF, 850nm, DOM
CAB-CONSOLE-RJ45	Console Cable 6ft with RJ45 and DB9F

Specification

WS-C2960S-24TS-L Specification	
Manufacturer	Cisco
Product ID:	WS-C2960S-24TS-L
Product Description:	Cisco CAT2960S Stack 24 Gige-4 x SFP LAN Base
Product Type:	Ethernet Switch
Marketing Information	
The Cisco Catalyst 2960-S and 2960 Series Switches with LAN Base provide the performance, and availability that today's small businesses demand, as well as the intelligence to support business applications and security services. Switches are a key component of your network foundation and can improve the availability of critical applications, while protecting business information. The Cisco Catalyst 2960-S and 2960 Series Switches are specifically designed for growing businesses that need to accommodate expanding services, and optimize network bandwidth and to assure the fast and reliable delivery of applications and services.	
Interfaces/Ports	
Number of Ports:	24
Gigabit Ethernet Port:	Yes
Interfaces/Ports:	24 x RJ-45 10/100/1000Base-T Network LAN
Media & Performance	
Forwarding/Filtering Rate:	41.7 Mpps
Switching Throughput:	176 Gbps
I/O Expansions	
Number of Expansion Slots:	5
Expansion Slots:	(4 Total) SFP (mini-GBIC) Uplink (1 Total) Stacking Module
Network & Communication	
Layer Support:	2
Management & Protocols	

Manageable:	Yes
Management:	DHCP QoS VLAN SNMP v1, v2, v3 Syslog CLI RMON CiscoWorks LAN Management Solution
Memory	
Standard Memory:	128MB
Memory Technology:	DRAM
Flash Memory:	64MB
Software	
Operating System:	Cisco IOS
Power Description	
Input Voltage:	110 V AC 220 V AC
Input Voltage Range:	100 V AC to 240 V AC
Power Source:	Power Supply
Redundant Power Supply:	Yes
Physical Characteristics	
Compatible Rack Unit:	1U
Form Factor:	Rack-mountable Stackable
Dimensions:	1.75" Height x 17.50" Width x 11.80" Depth
Weight (Approximate):	10 lb

شما میتوانید کلیه تجهیزات شبکه را با گارانتی و ضمانت اصالت کالا از [فروشگاه اینترنتی مستر شبکه](#) تهیه کنید.



مقالات مرتبط :

- [کانفیگ سوئیچ سیسکو](#)
- [ریکاروری پسورد سوئیچ 3850 و 2960](#)
- [انواع سوئیچ سیسکو 2960 و تفاوت آنها](#)
- [آموزش اساس نامگذاری سوئیچ های سیسکو](#)
- [راهنمای استفاده از سوئیچ های سیسکو 2960 \(قسمت اول\)](#)
- [14 نکته مهم در انتخاب سوئیچ شبکه](#)
- [نحوه آپدیت IOS سوئیچ سیسکو](#)
- [پیکر بندی VLAN بر روی سوئیچ سیسکو](#)